

**FOS-13**

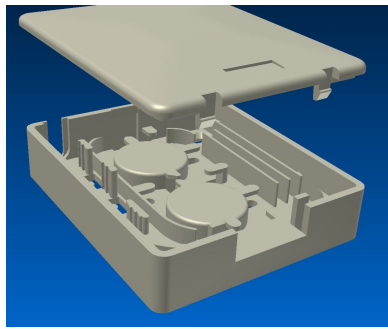

**FOS-19**

**FOS-13** and **FOS-19** are wall mounted outlets for optical cable supply for end user device.

Outlet **FOS-13** is designed for SC connector installing but **FOS-19** for Duplex-SC connector installing. Connectors in the outlet's body are fastened without screws.

Incoming cable and according connector is fastened on to outlets base. Pigtails can be added using 40 mm long splices or mechanical connector holder

Outlet is secured with cover. It can be fastened to wall with two 2mm screws.

Place for outlet's number sticker on cover surface. It is possible to order covers with customer's logo.

### *Technical specification*

Incoming cable diameter, mm	up to 9.0
Minimal bend range, mm	13.0
Welding space	2
Places for mechanical connections	2
Dimensions, mm	91.5*76.5*25.0
Weight, g	56
Material	ABS

### *Set includes*

- Termination box
- Cover
- Plastic tightening 100\*2.5 mm, 2 pcs.

### *Packing*

Plastic bag - 1 pcs.

Cardboard box - 100 pcs.